

Components Overview

COMPONENT	QUANTITY	
LH arm assy	1	
RH arm assy	1	
Hingle block assy	1	
Outer bush	2	
Inner bush	2	
Lock tab	2	
Lock screws	4	
Blanking Caps	2	

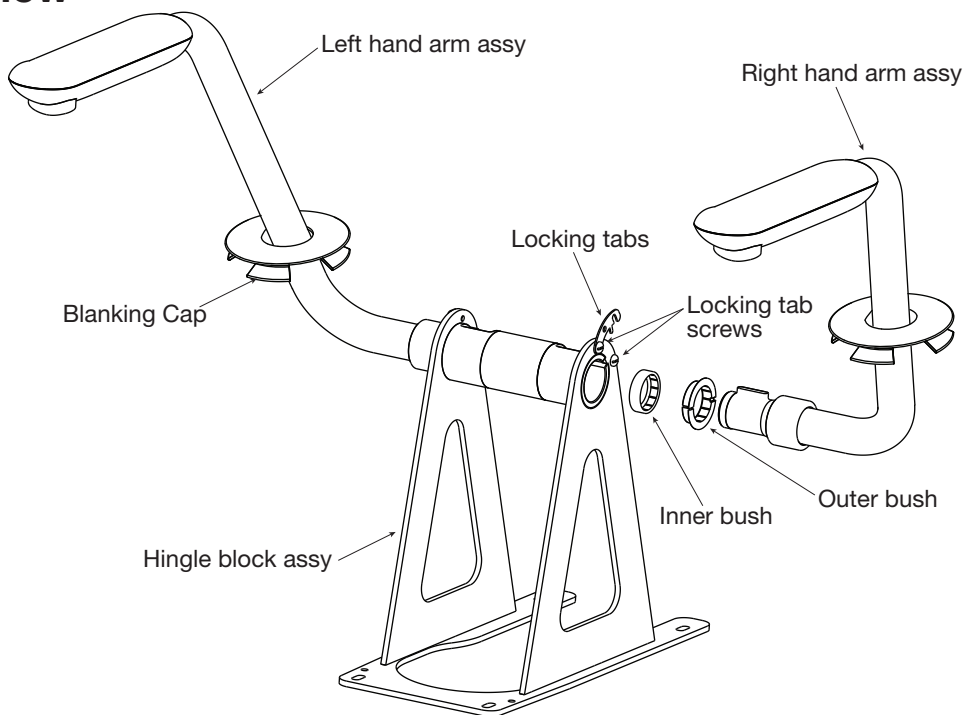

Fig. 1

1. Unpack and check all components as shown in **Fig. 1** above are supplied and unmarked. Fit unconnector into drainline if required before installing hinge block assembly (refer to pan installation instructions.)

Hinge Block Installation

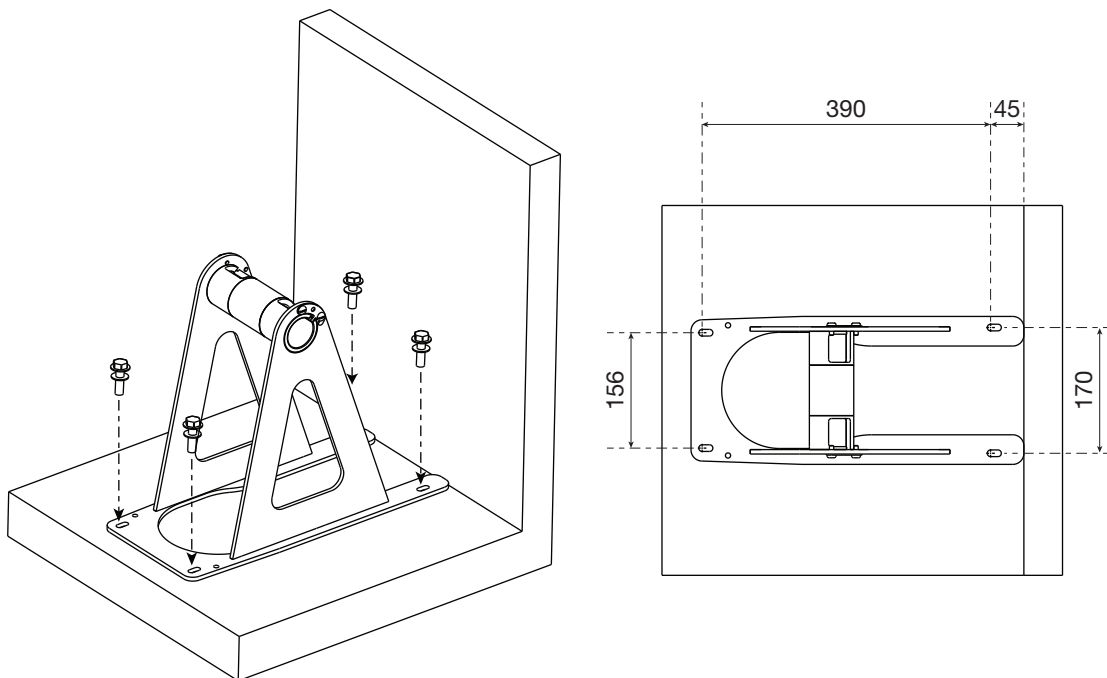

Fig. 2

2. Install hinge block flush with wall. Attach with 4 x fixing screws (not supplied) in positions shown above in **Fig. 2**. Use M8 dynabolts for masonry, or M8 coach screws for timber flooring.
IMPORTANT: Slide Care 800 pan over bracket and check hole alignment between pan and bracket before tightening bracket fixing screws

D82 Pan Fixing Bracket Assembly

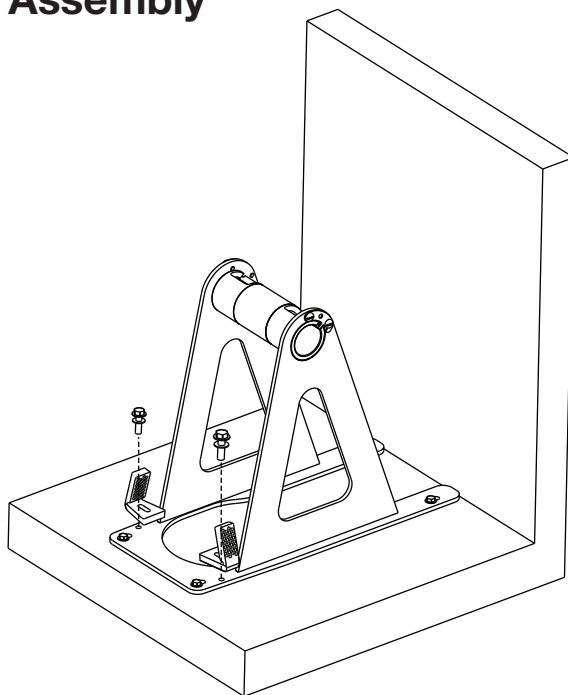

Fig. 3

3. Attach the two (2) D82 pan fixing brackets using supplied screws through the holes in the hinge bracket as shown above in **Fig. 3**. Ensure holes in pan line up with fixing brackets.

Care 800 Pan Installation

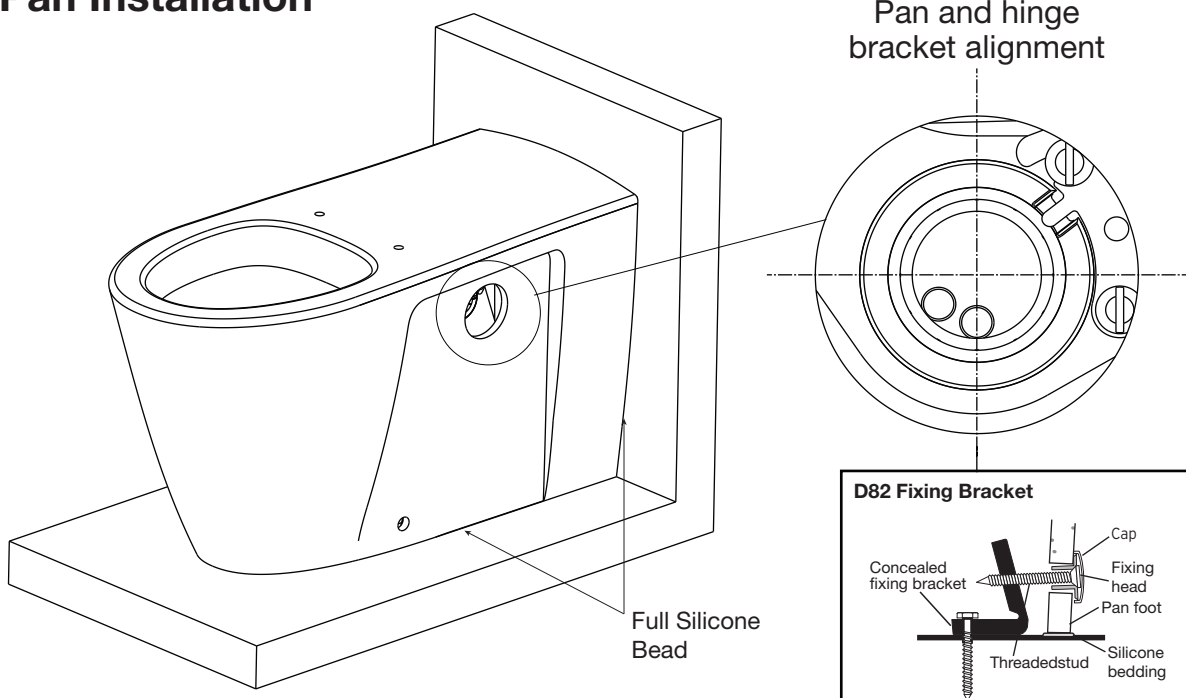

Fig. 4

4. Install Care 800 pan as specified in pan instructions. Ensure pan is centered over hingeblock. Ensure a full bead of silicone is used on both the foot and rear face. A strong bond is critical so ensure floor is clean and in good condition. Allow 24hrs for sealant to set before use

Arm Installation

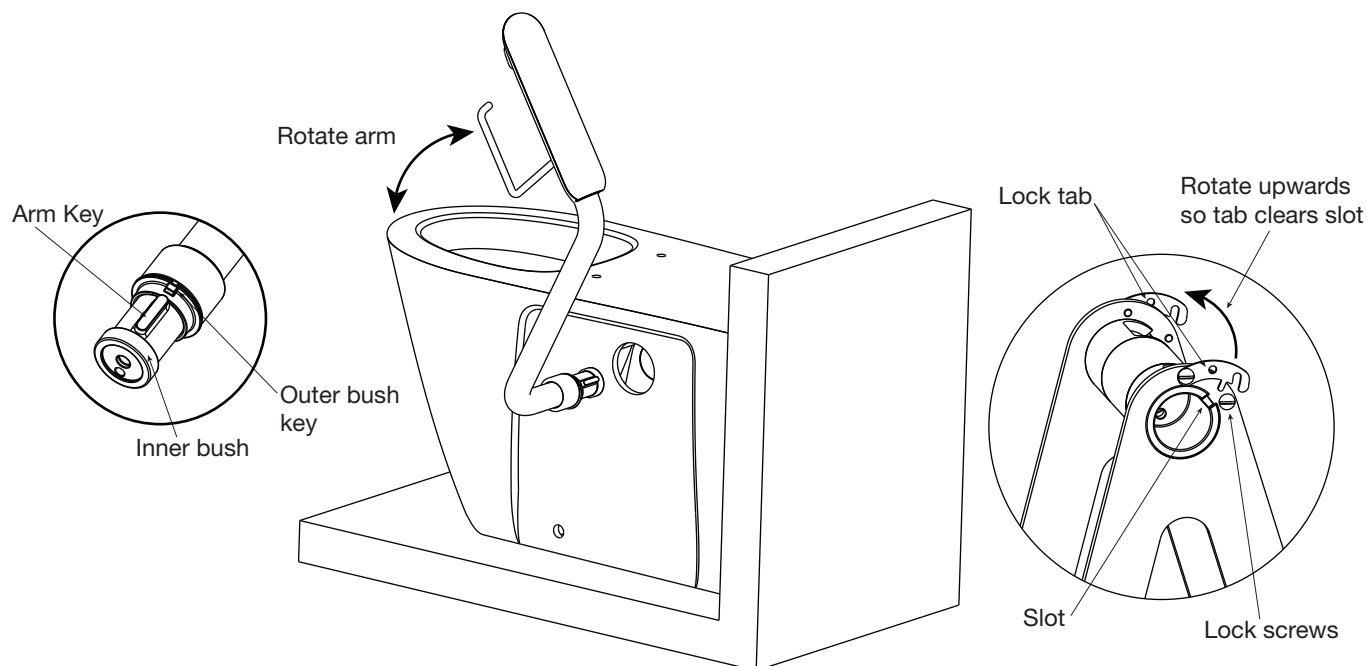

Fig. 5

5. Rotate lock tabs upwards so tab clears slot. Install inner and outer bushes ensuring outer bush key is aligned to arm key as shown above in **Fig. 5**. Install arms by tilting back and aligning key into slot. Ensure they rotate up and down and locking mechanism functions. Arms should lock in upper and lower position, button releases lock. Now rotate lock tab down into closed position.

Blanking Cap Installation

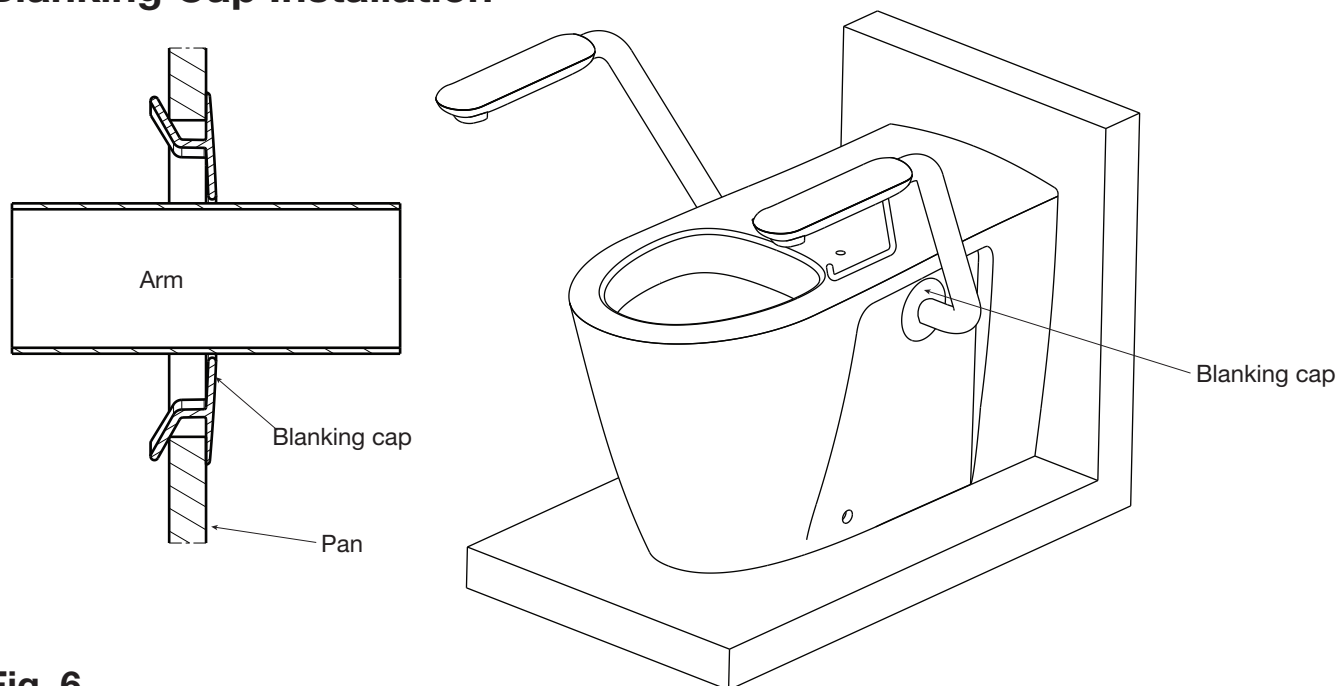

Fig. 6

6. Install blanking caps into pan, ensure cap is flush with outside of pan and there are no visible gaps (silicone may be used to secure cap to pan). Ensure caps do not interfere with arm movement.